

# **ANALOX MINI O2DII**

# **OPERATORS MANUAL**

Analox Sensor Technology Ltd  
15 Ellerbeck Court  
Stokesley Business Park  
Stokesley  
N. Yorks  
TS9 5JY

Tel: +44 (0)1642 711400  
Fax: +44 (0)1642 713900  
Email: [info@analox.net](mailto:info@analox.net)

## CONTENTS

|      |                              |    |
|------|------------------------------|----|
| 1.0  | Introduction.....            | 3  |
| 2.0  | Controls .....               | 4  |
| 3.0  | Air Calibration .....        | 5  |
| 4.0  | Pure Oxygen Calibration..... | 6  |
| 5.0  | Operation .....              | 7  |
| 6.0  | Accessories .....            | 8  |
| 7.0  | Troubleshooting.....         | 9  |
| 8.0  | Maintenance.....             | 10 |
| 9.0  | Care of the Mini O2DII.....  | 11 |
| 10.0 | Safety .....                 | 12 |
| 11.0 | Warranty Information.....    | 14 |
| 12.0 | Specifications.....          | 16 |
| 13.0 | Spares.....                  | 17 |
| 14.0 | Disposal.....                | 19 |

## **1.0 Introduction**

- 1.1 The Mini O2DII Oxygen Analyser is designed to measure Oxygen levels in the range 0.1-100% O<sub>2</sub>.
- 1.2 The analyser should be used for cylinder oxygen level verification or for monitoring a gas mixing panel but should not be used for both. If the analyser is used for measuring the oxygen level in the output from a mixing panel, another Mini O2DII should be used for cylinder verification purposes.
- 1.3 The Mini O2DII has a large digital display and operates from an internal temperature compensated minimum 2 year life electrochemical oxygen sensor. Power is provided by a 9V, 4000 hour life battery giving up to 3 year operation before replacement is necessary.
- 1.4 The Mini O2DII is a water resistant drop resistant totally self contained unit designed specifically for all the diving industry -Sport (NITROX), Commercial and Military - where hostile environmental conditions are the norm not the exception.
- 1.5 Your Mini O2DII is supplied ready to use. To preserve the life of the sensor a seal is fitted to the front of the sensor which must be removed before use. Please check the unit for damage and make sure the sensor seal is intact. If there is any damage, or the sensor seal is broken, or not in place, contact your supplier.

### **WARNING**

**It is important that  
these instructions are read  
before the analyser is used!**

## 2.0 Controls

- 2.1 The analyser is fitted with an on/off switch located on the side or front of the unit. Push the switch up or down to turn the unit on and return it to the central position to turn it off. When it is switched on the analyser's display will show an oxygen reading but do not use before calibration (see section 3.0).
- 2.2 The low battery warning is a battery symbol in the corner of the display. When present, change the batteries before using the instrument (see section 8.0 Maintenance).
- 2.3 A waterproof calibration knob is located on the front. Turn it fully from left to right and then fully left, the reading should increase and then decrease. (If the reading does not change see section 8.0 Maintenance).

### **WARNING**

**Do NOT use when  
the LOW BATTERY symbol is on!**

### **ANALOX MINI O2DII OXYGEN ANALYSER**

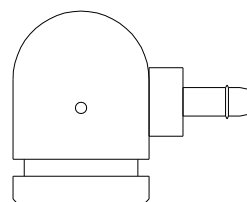
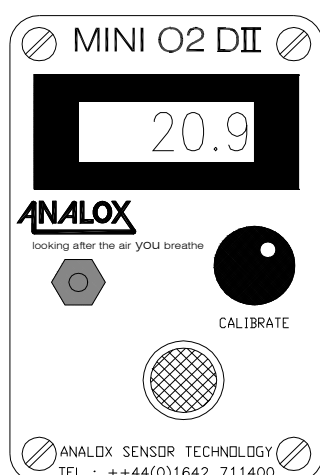

### **3.0 Air Calibration**

- 3.1 Air calibration is essential before every use and is performed as follows.
- 3.2 Ensure that the sensor seal and any flow adaptors are removed and the reading on the display has stabilised.
- 3.3 Expose the analyser to clean air for two minutes and adjust the calibration knob until the display reads the correct value using the humidity chart ( you can find the humidity chart on the inside of the back cover ). If this is not possible refer to paragraph 3.4 or to section 8.0 Maintenance.
- 3.4 It is possible that at very high altitude normal calibration is not achievable. In this event you must ascertain the actual pressure in BAR and multiply the atmospheric oxygen percent (20.9%) by this pressure and set the reading during calibration to the calculated level (this is the surface equivalent oxygen percentage). When you measure the level of oxygen in the sample you must divide the reading by the same atmospheric pressure value to obtain the true percentage of Oxygen in your sample.

For Example: At an atmospheric pressure of 0.8 BAR the surface equivalent oxygen percentage is  $20.9\% \times 0.8 = 16.7\%O_2$  Surface Equivalent. If the reading you then obtain from your sample is 32.0% you must divide this by 0.8 to obtain the true Oxygen percentage,  $32.0/0.8 = 40.0\%O_2$  True Percentage.

- 3.5 The analyser is now ready for oxygen measurement.

#### **WARNING**

**The analyser is sensitive to Oxygen partial pressure.  
Calibration must always be carried out at the same  
atmospheric pressure as Oxygen measurement.**

- 4.0 Pure Oxygen calibration for measuring oxygen purity up to 100%.**
- 4.1 Connect 100% bottled oxygen ( certified ) to the flow adaptor and adjust the flowrate to between 0.5 and 1.0 litre per minute.
- 4.2 Allow the reading to settle.
- 4.3 Expose to atmosphere, the reading should display +/- 0.4 of corrected humidity value i.e. between 20.5 and 21.3

## **5.0 Operation**

- 5.1 The Analox Mini O2DII comes complete with the unique DII adaptor which allows to you to directly apply the analyser to the outlet on your nitrox tank.
- 5.2 Ensure the sensor seal is removed. Connect the DII adaptor to the analyser by pushing the adaptor over the sensor turret. The O ring on the sensor should ensure a comfortable fit.
- 5.3 Hold the DII adaptor firmly against the cylinder outlet facing you. Very slowly open the pillar valve until gas can just be heard hissing through the flow adaptor.

### **WARNING**

#### **Open cylinder valve**

#### **EXTREMELY CAREFULLY**

- 5.4 Close the pillar valve after fifteen seconds when a stable reading is observed on the Mini O2DII.

If in doubt repeat the procedure taking care to ensure a very low gas flow.

- 5.5 Note that after a few seconds of the gas flow being stopped the reading will begin to change towards the level in the surrounding air of 20.9% O<sub>2</sub> you should therefore take the reading while flow is ON.

### **WARNING**

**Do not pressurise the sensor  
as inaccurate readings will result.**

## **6.0 Accessories**

### 6.1 Carrying/storage

The case supplied will contain the Mini O2DII plus the adaptor and moisture correction card.



## 7.0 Troubleshooting

| SYMPTOM   | REASON   | SOLUTION   |
|---|--|--|
| Battery symbol  | Low battery  | Change battery   |
| No display  | Switched off<br>Bad connection   | Switch on<br>Check display connection<br>Check battery connection                                |
| Zero reading  | Sensor disconnected<br>Sensor expired  | Check connection<br>Change sensor  |
| Reading erratic   | Pressure on sensor<br>Radio transmission<br>Sensor old or faulty<br>Condensation on sensor | Check flow<br>Move unit away<br>Change sensor<br>Dry sensor face                                 |
| Reading does not change when calibration knob is turned | Faulty connections<br>Sensor failure   | Check connections<br>Change sensor   |
| Display segments missing                                | Display faulty   | Return to dealer   |
| Will not calibrate                                      | Sensor faulty<br>Sensor not in air<br>High altitude  | Change sensor<br>Check flow adapter<br>Calculate percent equivalent = $20.9\% \times \text{bar}$ |
| Reading drifts  | Rapid temperature change   | Do not move analyser from one temperature to another immediately before use                      |

## **8.0 Maintenance**

### **8.1 Battery replacement.**

- a) Remove the 4 screws located at each corner of the unit and carefully lift the lid.
- b) Slide the battery out of its spring bracket and disconnect the lead.
- c) Connect the lead to the new battery and slide the battery behind the spring bracket.
- d) Replace the lid carefully and screw down taking care that the sensor locates properly.
- e) Ensure that you do not trap any wires.

### **8.2 Sensor replacement.**

- a) Replacement sensor part number: 9100-9212-5A
- b) Remove the 4 screws located at each corner of the unit and carefully lift the lid.
- c) Remove the flow adapter if fitted and slide the sensor out of the lid.
- d) Disconnect the in line sensor connector.
- e) Dispose of the old sensor according to local regulations for Lead and Potassium Hydroxide solution.
- f) Remove the new sensor from its bag and check it for leaks, connect to the inline connector and slide through the lid.
- g) Replace the lid carefully and screw down taking care that the sensor locates properly. Ensure that you do not trap any wires.

## 9.0 Care Of The Mini O2DII

- 9.1 Although designed to be water resistant the Mini O2DII should not be intentionally immersed in liquid or left outside unprotected.
- 9.2 The Mini O2DII is built to resist the effects of day to day shocks and drops but remember it is a precision oxygen analyser and should be looked after carefully to give long trouble free service.
- 9.3 To clean the Mini O2DII use a damp soft cloth.
- 9.4 Protect the Mini O2DII from long periods of direct sunlight and do not subject it to high or low temperature extremes.
- 9.5 The sensor in the Mini O2DII is an electrochemical device and contains a caustic electrolyte. Always check to make sure that it is not leaking and do not allow it onto any part of your body or clothing. In the event that you do come into contact with the electrolyte wash the contaminated part with copious amounts of water -see Safety Information.

ANALOX 9212  
OXYGEN SENSOR



### **WARNING**

**If after handling the sensor  
your fingers or other part of your  
body feels slippery or stings  
wash with a lot of water.**

**If stinging persists get medical  
attention!**

## 14.0 Safety Information Mini O2DII

- 10.1 When the life of the battery has expired it should be disposed of safely in accordance with local regulations.
- 10.2 When the life of the sensor has expired or it is leaking or otherwise damaged it must be disposed of safely in accordance with local regulations.
- 10.3 The sensor contains KOH Potassium Hydroxide solution which is hazardous and can have the following effects:

|           |  |
|-----------|--|
| Skin      | Potassium Hydroxide is corrosive – skin contact could result in a chemical burn. |
| Ingestion | Can be harmful or FATAL if swallowed.  |
| Eye       | Contact can result in the permanent loss of sight.                               |

### First Aid Procedures.

|           |  |
|-----------|--|
| Skin      | Wash the affected part with a lot of water and remove contaminated clothing. If stinging persists get medical attention. |
| Ingestion | Drink a lot of fresh water. Do not induce vomiting. Get medical attention.   |
| Eye       | Wash with a lot of water for at least 15 minutes and get medical help immediately.                                       |

## 10.4 Sensor Handling Information.

Mini O2DII oxygen sensors are supplied normally in sealed bags. Before the bag is opened check that the sensor has not leaked. The sensors are themselves sealed and do not under normal circumstances present a health hazard however if leakage of the Potassium Hydroxide electrolyte has occurred use rubber gloves and wear chemical splash goggles to handle and clean up. Rinse contaminated surfaces with water.

## 11.0

We provide the following Warranties for the Analox O2DII:

A 2 year graded sensor warranty.

A 2 year electronics warranty.

In both cases the Warranty period runs from the date of our Invoice.

We warrant that the equipment will be free from defects in workmanship and materials.

The Warranty does not extend to and we will not be liable for defects caused by the effects of normal wear and tear, erosion, corrosion, fire, explosion, misuse, use in any context or application for which the equipment is not designed or recommended, or unauthorised modification.

Following a valid Warranty claim in accordance with the above, the equipment, upon return to us, would be repaired or replaced without cost or charge but in our discretion we may elect instead to provide to you which ever is the lesser of the cost of replacement or a refund of net purchase price paid as per our Invoice on initial purchase from us. We shall have no liability for losses, damages, costs or delays whatsoever. We shall have no liability for any incidental or consequential losses or damages. All express or implied warranties as to satisfactory or merchantable quality, fitness for a particular or general purpose or otherwise are excluded and no such Warranties are made or

provided, save as set out in this Clause 7.

In order to effectively notify a Warranty claim, the claim with all relevant information and documentation should be sent in writing to:

Analox Sensor Technology Limited  
15 Ellerbeck Court  
Stokesley Business Park  
Stokesley  
North Yorkshire  
TS9 5PT

Or by e-mail to : [info@analox.net](mailto:info@analox.net)

Or by Fax to : +44 1642 713900

We reserve the right to require from you proof of dispatch to us of the notification of Warranty claim by any of the above alternative means.

The equipment should not be sent to us without our prior written authority. All shipping and Insurance costs of returned equipment are to be born by you and at your risk. All returned items must be properly and sufficiently packed.

## 12.0 Specifications

|                  |  |
|------------------|--|
| Range            | 0.1 -100.0% Oxygen   |
| Typical Accuracy | +/-1% of reading over range<br>0-50% when calibrated on air<br>in accordance with the manual.<br>+/-2% of reading over range<br>0-100% when calibrated on<br>certified pure Oxygen in<br>accordance with the manual. |
| Resolution       | 0.1% Oxygen  |
| Response time    | 90% in less than 15 seconds  |
| Sensor Type      | Analox 9212-5  |
| Sensor Life      | More than 36 months in air.<br>24 month guarantee in air.  |
| Battery          | 9V Alkaline (PP3)  |
| Battery Life     | 4000 Hours. Upto 36 months<br>intermittent use.  |
| Operating temp   | -5 to 50 C   |
| Storage temp.    | -5 to 50 C   |
| Pressure         | Sensitive to the partial pressure of<br>Oxygen.  |



## 13.0 Spares

Your Mini O2DII unit is supplied with an Analox Oxygen sensor 9212-5D, a 9v battery and 1 high pressure DII adaptor.

You are able to purchase these spares directly from us on

Tel: +44 (0)1642 711400, Fax: +44 (0)1642 713900 or you can buy them directly from our website [www.analox.net](http://www.analox.net).

9100-9212-5D Spare oxygen cell for the Analox Mini O2DII

8000-0002A High pressure DII adaptor

Visit [www.analox.net](http://www.analox.net)

Nitrox page, for news and views on nitrox diving.

If you have any comments or queries about the Mini O2DII please contact us on Tel: +44 (0)1642 711400 or Fax: +44 (0)1642 713900

Email: [info@analox.net](mailto:info@analox.net) or visit our website

**[www.analox.net](http://www.analox.net)**

## 14.0 Disposal



According to WEEE regulation this electronic product can not be placed in household waste bins. Please check local regulations for information on the disposal of electronic products in your area.